

# Specification Sheet

Item: Handmade stainless steel sink (drainboard bowl) – 9645R

Specification:

Overall size: 960×450×228mm

Bowl size: 510×400×228mm

Stainless steel: 304

Thickness: 1.5mm / 16gauge

Corner: R10 corner

Finish: stain

Net weight:9.7kg

Gross weight:12.1kg

Accessories: strainer, roll mat,stone painting, sound pads, clips, cut template template.

## Drawing:

### HAND MADE STAINLESS STEEL SINK

Dimensions: 37 3/4in.L x 17 3/4in.W x 9in.H

Material: SUS304 16Gauge

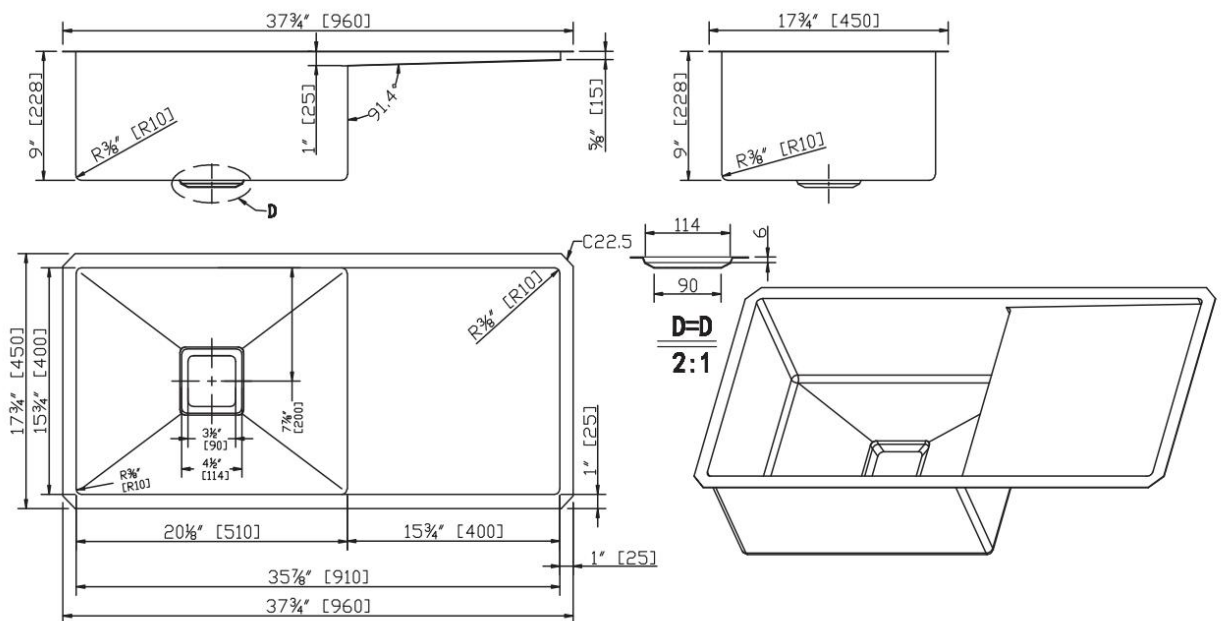

**Actual Photo:**

1. Front View & lateral view --- Good looking, perfect stain finish, with high quality sound pad and spray painting,



Roll Mat & Grid

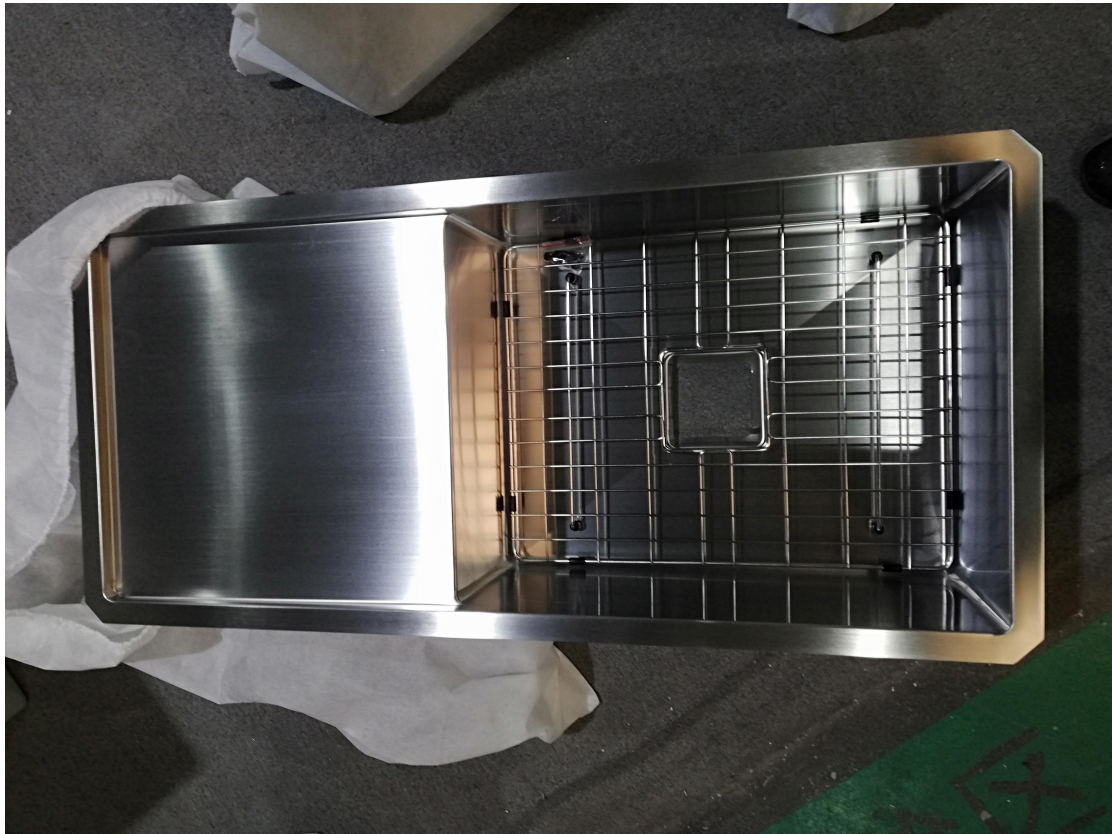

Strainer





Length: 960mm



Width:450mm



Height:228mm



### **Packaging Procedure**

1. Use Non-woven bag to pack the sink , then put the sink inside the polly foam.
2. The cut our template is on the sink.
3. Total 2 polly foam around two side of the sink, and protective strips around the box , 100% protect the safety of the sink
- 4.Outer Carton Box





